

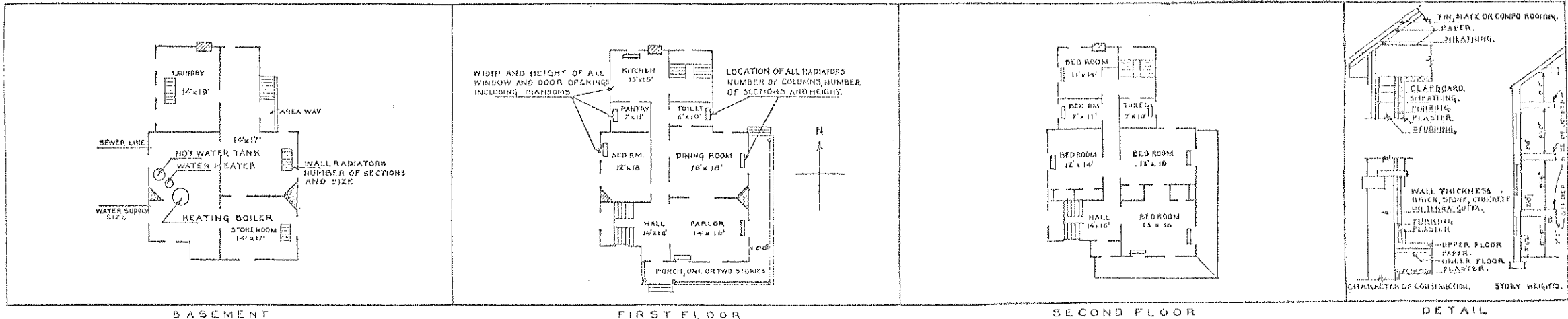

20



BASEMENT FIRST FLOOR SECOND FLOOR  
 IN SPACE BELOW SKETCH BASEMENT AND FLOOR PLANS OF BUILDINGS, GIVING DATA AS PER PLANS ABOVE

<div style="display: flex; align-items: center; justify-content: center;"> </div>
---

REMARKS

\_\_\_\_\_

\_\_\_\_\_

\_\_\_\_\_

\_\_\_\_\_

\_\_\_\_\_

\_\_\_\_\_

\_\_\_\_\_



## SUPPLEMENTAL SHEET

BUILDING #36

## REPAIRS, ALTERATIONS, REPLACEMENTS

DATE	REPAIRS, ALTERATIONS, INSTALLATIONS AND REPLACEMENTS	COST
Dec. 1925	Roof rebuilt Started December 16, 1925 completed April 4, 1926	4803.20
F.Y. 1931	25 - 89B boxes, feed, G.I. in building CV 786	
Aug. 1934	1 - meter, elec. Wathour, 5 Amp. 115 v. 60 cycle. #4903375 installed - 2nd qrt	
F.Y. 1938	1" copper line from water main to building installed replacing old service line	
F.Y. 1938	Bldg #36 - Stables - Installed hasps and staples on two doors Installed new service and grounding WPA	41.50
June 1940	Installed 1 boiler, 2720 sq.ft. of radiation. Radiators: 2 A-26" 5-tube, 20 section, 18 B-26" 4-tube, 12 section, 1 C-23" 5-tube, 17 section, 8 D-28" 6-tube, 20 section. 3 lgths pipe, steel, black, 2 1/2", 13 lgths. pipe, steel, black, 2", 22 lgths. pipe, steel, black, 3/4". 1 steam tees C.I. 2 1/2"x2 1/2", 1 steam tees C.I. 2 1/2"x2", 3 steam tees C.I. 2", 20 steam tees C.I. 3/4". 16 steam ells, C.I. 2 1/2", 120 steam ells, C.I. 3/4". 20 ground joint unions 3/3 inch. Voucher No. DV-2789-0	846.48
June 1940	Installed 3/4 reflectors, 12 inch.	25.50
June 1940	<del>Installed 3/4 balcons, shade, weatherproof.</del> Voucher No. DV-2739-0.	<del>1.00</del>
June 1940	Installed 1 expansion tank complete w/reducing valve, relief valve, etc. Voucher No. DV-2788-0	17.00
July 1940	Installed 1 unit heater, Burnham #46E61; 1 gate valve, 2"; 1 Gate valve 1-1/2"; Tees, cast iron, 2 A-2-1/2"x 1-1/4", 2 B-2-1/2"x2"x1", 1 C-2-1/2"x1-1/2"x1-1/4", 1 D-2"x1-1/4"bd-1/4", 1 E-1-1/2"x3/4"x1-1/2", 1 F-2"x1/2"x2", 1 G-2-1/2"x 1/2"x2-1/2", 1 H-2-1/2", 1 I-2-1/2"x1/2", 1 J-1/2", 1 K-1-1/2"x1/2"; Elbows, cast iron, 1 A-1-1/2"x1-1/4", 6 B-2", 6 C-1-1/2", 6 D-1-1/4" 45°, 2 E-1" 45°, 4 G-1"; Nipples, asstd. cast iron, 12 A-1-1/4", 4 B-1", 4 C-2", 6 D-1-1/2"; Pipe steel, black, 20' lengths, 60 A-2", 40 B-2-1/2", 60 C-1-1/2", 60 D- 1-1/4", 20 E-1"; 1 valve, stop, 1/2", 1 tee, C.I. galv. 3/4"x1/2"; 30 pipe, covering, asbestos, A-2"; 36 pipe, covering, asbestos, B-1-1/2"; 24 pipe, covering, asbestos, C-2-1/2" and 1 standard thrush dual control. Voucher No. DV-2814-0.	146.96
July 1940	Installed 6 Arco valves, for type M pipe, 2". Voucher No. DV-198-1.	20.84
July 1940	Installed 20 lgths. soil pipe, single hub. 5" extra heavy; 20 lgths. soil pipe, single hub. 4" extra heavy; 10 lgths. soil pipe, double hub. 5" extra heavy; 10 lgths. pipe, soil, double hub. 4" extra heavy; 1 lgths. soil pipe, double hub. 6" extra heavy; 1 soil pipe, fittings, 6x5, extra heavy; 15 soil pipe fittings, 5x4, extra heavy; 9 soil pipe fittings, 4x2, extra heavy; 4 soil pipe fittings, 4", extra heavy; 3 soil pipe bends, fittings, 5" extra heavy 1/8B; 10 soil pipe fittings bends, 4" extra heavy 1/8B; 21 soil pipe fittings bends, 4" extra heavy 1/4B and 200 ft. copper tubing, seamless, 2"; Fittings, copper pipe, couplings, 8 - 2-2" C x 2", No. A 1672, 6 - 1-1/2" C x 1-1/2 No. A 1624; 2 fittings, copper, tees, A-2" C x 2" C x 1", No. A 2706; 6 fittings, copper, waste tees, 1-1/4" C x 1-1/4" C x 1-1/4" C	217.07

REFRIG., AIR-CONDITIONING, REFRIGERATORS AND INSTALLATIONS.		COST	PAGE 186
July 1940	Installed 6 lavatories, with pop up waste, faucets and C.F.S. trap, enameled iron; 6 floor drains; 3 lgths. pipe, galv. iron, 2"; 2 lgths. pipe, black iron, 1/4"; 1 curb cock, 2"; Compression stop and waste cocks for copper pipe, 1 - A-2", 2 - B-1-1/2"; 2 drain cocks, 3/4". Voucher No. DV-205-1	104.75	310
July 1940	Installed 6 window frames and sash, tripple, size 3'0x4/2-1-1/2", glazed; 2 window frames and sash, single, Mullion; 22 window frames and sash, single, Mullion; 3 entrance door frames, door side; and 9 storm sash, size 3'0"x6'6" by 1-1/4", fir, 12 lights, glazed. Voucher No. DV-208-1.	523.05	
July 1940	Installed 1 hot water tank heater, 12" grate #112. Voucher No. DV-278-1	35.00	
Aug/40	Installed 3 - Urinals, pedestal type w/flush valve, 1 tank, hot water, storage, galv iron, vertical type with manhole plate, 6 Traps "P" G.I. 2", 2 Fittings, soil pipe "Y" 4" Extra Heavy, 3 cleanouts, 4" with counter sunk plug, 4 ea reducers, 1/2 x 1/2, 200 ft. tubing, copper, seamless, 1 1/2" 100 ft. tubing, copper, seamless 1", 100 ft. 3/4", 140 ft. 1/2", 2 ea cocks, compression stop and waste for copper pipe, 1", 6 ea 3/4", 4 ea 1 1/2", 18 ea fittings, copper pipe couplings, 1/2" c x 1/2", 12 ea, 1/2" CX 1/4", 10 each 2" C x 2", 10 each 1 1/2" C x 1 1/2", 2 each Ells, Copper, fittings, 2" C x 1", 12 ea 2" Cx2", 12 ea 1 1/2" C x 1 1/2", 24 each 1" C x 1", 4 ea 2" C x 2", 4 ea 1 1/2" C x 1 1/2" C, 8 each 1" C x 1" C, 12 each 3/4" Cx 3/4" C, 12 each 1/2" c x 1/2" C, 2 ea tees, copper fittings 2" C x 1" C, 4 each 2" C x 2" x 1 1/2" C, 8 each Tees, copper, fittings 1 1/2" Cx1 1/2" Cx1" C, 12 each 1" Cx1" Cx3/4", 12 each 1" Cx1" Cx1/2" C, 2 each 2" Cx1 1/2" Cx1" C	310;33	
Aug/40	Installed 12 water closets with seats and valves, siphon jet type, 22.50 each, 4 each exposed shower fixtures, type 2, cost 7.25 each, 1 each damper regulator for tank heater, each \$3.75 ; 1 cleanout, 5" plug counter seat, cost, each 85¢; 4 each pipe, galv. iron, 1 1/2", cost lgth \$2.48, 2 each pipe, black iron, 1/8", cost length, 55¢; 4 each corporation coacks w/lead service connection, 1 inch, cost each 2.00	322.62	
July 1940	Installed 6 window frames & sash, tripple, size 3'0 x 4/2 - 1 1/2" glazed. Installed 1 window frame & sash, single, Mullion. Installed 22 window frames & sash, single. Installed 3 entrance door frames - doors side. Installed 9 storm sash, size 3' 0" by 6'6" by 1-1/4", fir, 12 lights, glazed. Voucher No. DV 208-1	509.85	
October 1940	Installed 1 circulator, water, M40325K. Installed 2 acquastats, L44461X. Installed 1 Meter, heat regulator M26ALX. Installed 1 relay, RL2ALK. Installed 1 chromotherm, TLLALK. Voucher No. DV 1432-1	54.75	
September 1940	Installed 1 meter, sgle. phase, 25 Amp.; 28 covers, 2" porc.; 22 covers, 3" porc.; 2500 ft. cable, 11/2, armored; 250 ft. cable, 11/3, armored; 24 boxes, 2 1/2, round; 12 cases, 2", wall; 10 switches, GE 2841; 500 ft. wire, black, #6 DRAC str.; 500 ft. white wire, #6 DRAC str.; 500 ft. wire, black, #8 DRAC sol.; 500 ft. wire, white, #8 DRAC sol.; 1 switch, safety, #97313, 100 Amp. 3W SR; 24 boxes, 4", rd.; 12 cases, wall, 2 1/2"; 10 racks & spools, secondary, 3 spool, heavy duty; 56 boxes, 3" round; 40 ft. conduit, 1", galv.; 2 bendhicks, 1"; 2 clamps, 1", ground; 50 ft. cable, 2/2, ground; 200 textolite bodies GE 2710; 200 textolite caps, GE 2701; 8 switches, 20 Asp. 97211-C; 10 plates, switch, single pole flush; 60 connectors, BX; 8 boxes, X Gen; 2 caps, service, 1"; 40 connectors, BX; 6 plates, single pole flush switch; 3000 ft. cable, wire, 11/2; 120 boxes, X Gen; 1 meter, 50 amp., 110-220 V; 1 hood, 1"; 1 Bendhick, 1"; 250 ft. cable, armored, 11/3; 2500 ft. wire, wpl. No. 6 T.B.; 1500 ft. wire, wpl. No. 4 T.B.; 1 switch, safety, S.W. 100 Amp. 3 wire; 1000 ft. cable, armored, 1 1/2; 100 caps, rubber attachment plug; 400 bakelite push button sockets with cord grip cap; and 4 cutouts, primary 30 amp., 5000 V. Voucher No. DV 1319-1	172.68	
November 1940	Installed 4 mirrors, 24 x 42 x 1/4 with frames. Voucher No. DV 1473-1	39.00	
Jan. 1941	Installed 6 faucets, sink C.P. #1. Voucher No. CV-2795-1.		
April, 1941	Installed 1 Mirror. Voucher No. DV 1520-1.	2.75	

(30)

## SUPPLEMENTAL SHEET

BUILDING #36

REPAIRS, ALTERATIONS, REPLACEMENTS AND INSTALLATIONS

DATE	REPAIRS, ALTERATIONS, REPLACEMENTS AND INSTALLATIONS	COST
Nov. 1941	Constructed Winterized Porch. Size 12' x 31'.	910.11
	Installed in course of completion: 1 Aquostat. Voucher No. CV 1389-2	6.90